

Hey, Home Schoolers! We'll be looking for you at

HOME SCHOOL DAY

APRIL 15, 2025

at the Eisenhower Presidential
Library and Museum
in Abilene, KS

Check-in at 9:00 AM in
the Library Lobby

Programs run from
9:30 AM - 12:30 PM

FREE for students ages 5-18
\$5 per adult

Come & Go Activities and
Ticketed Programs
will be offered.

This event is exclusive to home school
students in grades K-12. It is not
appropriate for Pre-K children.

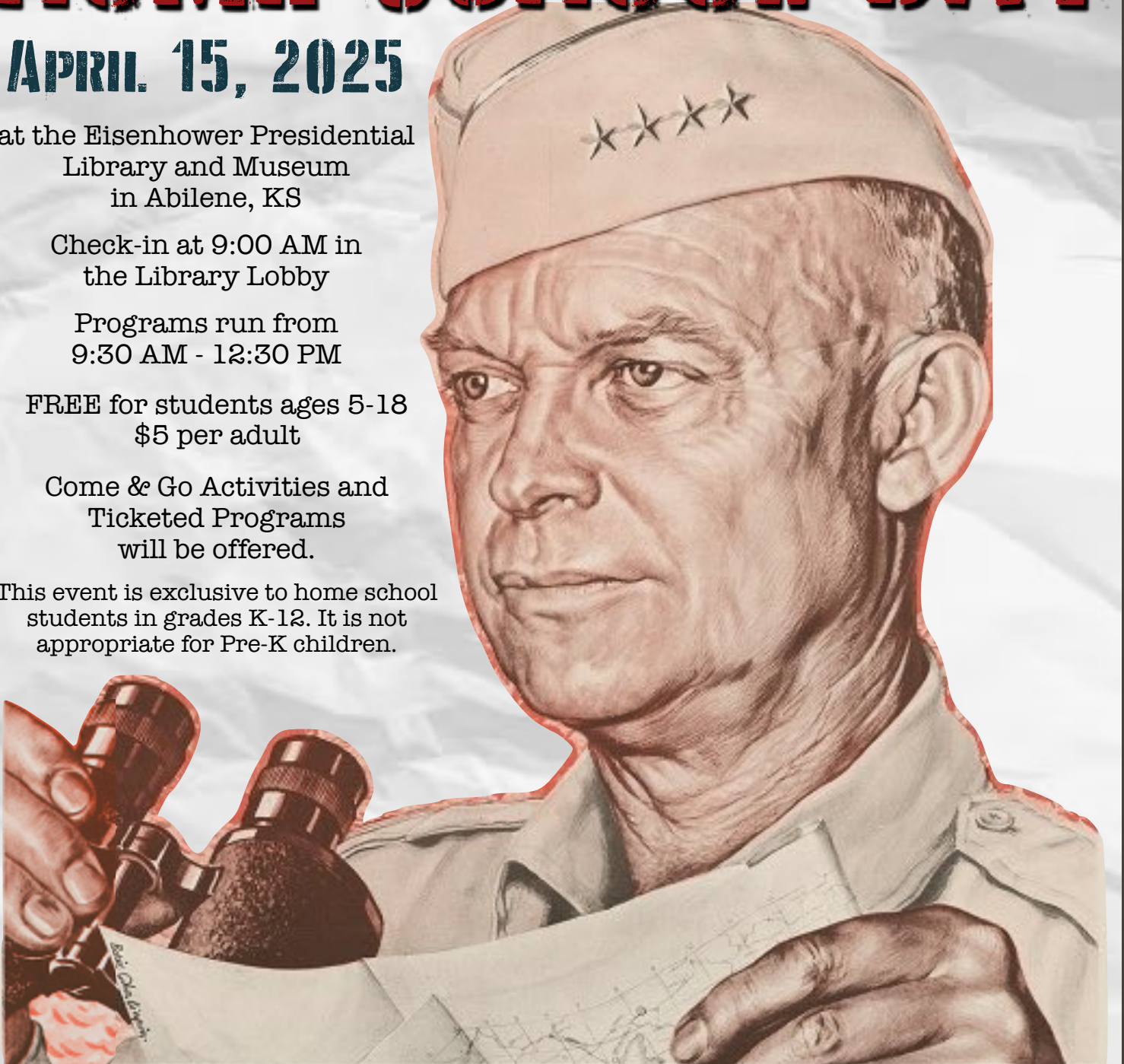

TOPIC: WORLD WAR II

Learn more and register by April 1st
at www.IKEducation.com or by scanning the QR Code.



9:00 AM - Your first stop of the day needs to be at check-in in the lobby of the Presidential Library. Please have your students' schedules drafted and ready to go.

Come & Go Activity options

time	location	activity	grades	ages
9:30 AM - 12:30 PM	Library Courtyard	War Games	K-12th	5-17 years-old
9:00 AM - 12:30 PM*	Presidential Museum*	Self-guided search in the WWII galleries**	K-12th	5-17 years-old

* The Eisenhower Presidential Library, Museum, Visitors' Center, and Place of Meditation are open to the public from 9:00 am - 4:30 pm. Your proof of paid registration to Home School Day allows you to visit them on your own even after our planned activities are over. This may be helpful as you plan your day's schedule. This free admission is good only for April 15, 2025.

** An IKEducator will be at a table in the lobby to hand out the search activity. Use the museum map below to find the World War II galleries within the museum. They are the third "America Goes to War" gallery and the fourth "Leading to Victory" gallery. IKEducators will also be in the galleries to offer assistance.

Eisenhower Presidential Museum

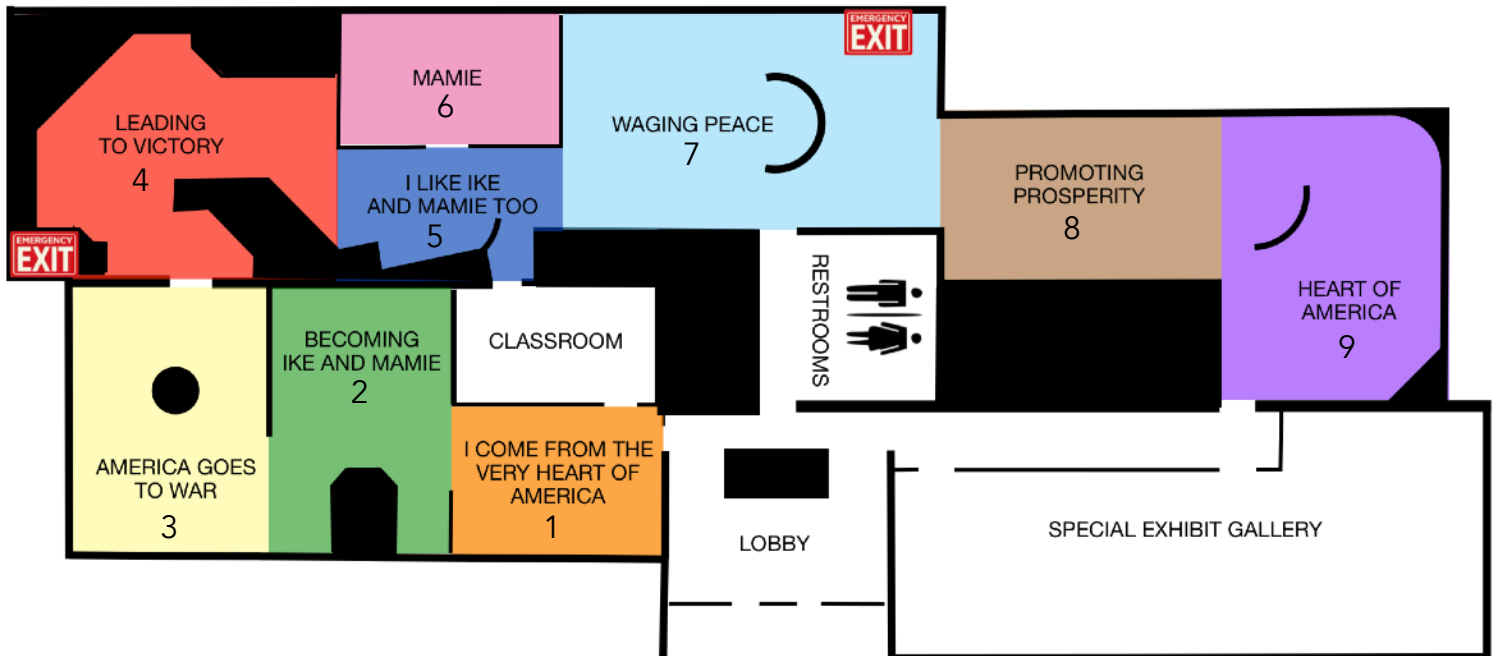

Ticketed Program options

Tickets will be first-come, first-served at check-in for K-12 students. Please respect the start and stop times of ticketed programs. Learn more about each program and activity in the later pages of this packet.

Session 1: 9:30
 Session 2: 10:30
 Session 3: 11:30

time	location	program	grades	ages
Ticket Required 9:30 - 10:15 AM	Library Auditorium (line up in hallway) Limit 24 students	<i>Little Ike Storytime: Parachute</i>	K- 3rd	5-8 years-old
Ticket Required 9:30 - 10:15 AM	Visitors' Center (enter through NE door, by the flag) limit 28 students	<i>Code Talkers</i>	4th - 7th	9-12 years-old
Ticket Required 9:30 - 11 AM	Museum Classroom (line up in lobby) Limit 24 students	<i>Attic Artifacts: Band of Brothers</i>	8th-12th	13-17 years-old
Ticket Required 10:30 - 11:15 AM	Library Auditorium (line up in hallway) Limit 24 students	<i>Little Ike Storytime: Parachute</i>	K- 3rd	5-8 years-old
Ticket Required 10:30 - 11:15 AM	Visitors' Center (enter through NE door, by the flag) limit 28 students	<i>Code Talkers</i>	4th - 7th	9-12 years-old
Ticket Required 11:30 - 12:15 PM	Library Auditorium (line up in hallway) Limit 24 students	<i>Little Ike Storytime: Parachute</i>	K- 3rd	5-8 years-old
Ticket Required 11:30 - 12:15 PM	Visitors' Center (enter through NE door, by the flag) limit 28 students	<i>Code Talkers</i>	4th - 7th	9-12 years-old
Ticket Required 11:30 - 12:20 PM	Museum Classroom (line up in lobby) Limit 24 students	<i>Primarily Omaha Beach</i>	8th-12th	13-17 years-old



IKEducation flags designate the entrances to programs.



QA

Commonly Asked Questions

Do I have to pre-register?

We *highly recommend* it. If you have not pre-registered, we cannot guarantee availability. We need to know how many supplies to have ready, and some of our programs have limited seats. Those seats go first to pre-registered K-12 students.

Do I have to arrive before check-in closes at 9:30 AM?

Yes. Without the tickets and proof of payment provided at check-in, you will not be allowed entry.

What if my number of attendees change after I have pre-registered?

That's okay, just make the changes at check-in.

I am an Active Duty or Retired military veteran. Do I pay the \$5 registration fee?

Not a penny! We celebrate our Active Duty or Retired military veterans with free entry and gratitude for their service!

Can I get tickets for multiple programs?

When you check-in, you may choose one ticket per K-12 student for a specific time slot. We will not give out "just in case" tickets that would prevent other students from having a spot. Please spend time scheduling out your day for each of your students in order to request only the tickets you will use.

May I bring my pre-K children?

Our programs are not appropriate for pre-K, or children under five years-old. Seating and materials are intended for the K-12 students. If you do bring a pre-K child, please remove them from the room if they become a distraction. Please note that strollers are not allowed in the Museum Classroom.

May my older children attend programs without an adult present?

Yes. Children 9 years-old or above may attend programs on their own while you escort younger children to other programs. However, parents may not leave campus.

May I pay with cash at check-in?

If you did not pre-register and pay online, we will have iPads available for you to do so at check-in. We can accept exact cash payment at check-in, but we cannot provide change.

What about the Boyhood Home?

Tickets to tour the Boyhood Home are NOT included in this Home School Day. Due to changes mandated by the federal government, the Boyhood Home may currently be closed to all visitors. You will need to check with the Visitors' Center for the current status. If you *are* able to purchase tickets to the Boyhood Home, please make sure you don't get them for a time when you already have tickets to a program.

Is food available for purchase on campus?

No. Visitors may picnic on the outdoor areas of our spacious campus, but food is not available for purchase. Abilene does provide a variety of fast food options. Just next door to our campus, you will find a Casey's convenience store and an Original Grande.

Have other questions?

Please send us an email at IKEd1890@EisenhowerFoundation.net.

Ticketed Program options



Little Ike Storytime: Parachute Grades K-3

Offered at 9:30-10:15 • 10:30-11:15 • 11:30 - 12:15

Presidential Library Auditorium

Under the command of General Dwight D. Eisenhower, paratroopers of the 101st Airborne were among the first Allied troops to land in France in the D-Day invasion on June 6, 1944. These men put their lives on the line as they jumped out of airplanes and into enemy territory. The bravery and courage they showed to restore freedom for others cannot be calculated.

IKEducation introduces young historians to this bit of history as a springboard for the book, *Parachute*, by Danny Parker (Author) and Matt Ottley (Illustrator). It is a heartwarming story about facing one's fears: *Toby doesn't like heights. That's why he always carries a parachute with him. His parachute makes him feel safe when he has to climb down from his bunk bed or when he's playing on the swings. But one day, Toby's cat gets stuck in a tree, and it's up to Toby to rescue him. With the help of his parachute, Toby reaches his cat and lowers him safely to the ground. But now Toby is stuck in the tree, unless he can conquer his fears. . . .*



Code Talkers

Grades 4th - 7th

Offered at 9:30-10:15 • 10:30-11:15 • 11:30 - 12:15

Visitors' Center - enter through the NE door, by the IKEducation flag



Numerous tactics were used by the U.S. military to disguise messages and secret information from our World War II enemies. This program introduces the *Code Talkers*, Native American men who served in the U.S. military and used their native languages to create codes that were never broken, even after the end of the war. Students will learn to decipher messages using the basics of this secret code.



Attic Artifacts: Band of Brothers Grades 8th - 12th

Offered at 9:30 - 11:00

Presidential Museum Classroom - line up in lobby

Many soldiers brought home souvenirs and kept items from their time in World War II. In this program, students critically evaluate images, documents, and a variety of artifacts from the legendary Easy Co. 101st Airborne's journey from the D-Day invasion to the liberation of Europe.



Primarily Omaha Beach

Grades 8th - 12th

Offered at 11:30 - 12:20

Presidential Museum Classroom - line up in lobby

It is said that the defeat of Nazi Germany was sealed on Omaha Beach. One hundred and sixty-thousand troops landed within 24 hours on a 50-mile front. Students are introduced to the overall objective of D-Day and how its story is preserved through primary sources. They then apply that knowledge through examination of documents and artifacts from Omaha Beach.

Come & Go Activity options

These activities run from **9:30 AM - 12:30 PM** and are open for grades **K-12**.

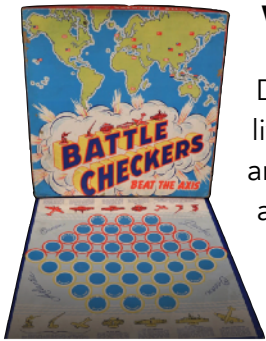

War Games

Library Courtyard

During WWII, images of the war were integrated into nearly every part of children's lives on the American home front, from toys and puzzles to comic books, cartoons, and board games. By engaging with toys that mirrored the war effort, children found a way to participate in something that would have otherwise excluded them, allowing them to claim a place in the nation's collective identity as patriots.

World War II-themed games remain popular in modern culture. Explore primary sources from the World War II era, then experience a contemporary war game.



WWII Galleries

Museum Lobby and World War II Galleries

Pick up a grade-appropriate activity sheet in the museum lobby and explore the two galleries of the Presidential Museum that focus on World War II.



Also available **FREE** today from 9:00 am - 4:30 pm

with proof of paid registration to Home School Day:

(No activities will be provided at these, but you are welcome to come & go and learn!)

IKE: An American Hero video. This 25 minute video starts at the :15 and :45 of each hour in the south auditorium of the Visitors' Center. It gives an overview of Ike's life.

Place of Meditation. This is the small chapel and is the final resting place of Dwight, Mamie, and their first son, Doud Dwight, who died from scarlet fever as a child.

A Window to the Past video. This 10 minute video will run in a loop in the auditorium of the Presidential Library. It will begin showing after the Home School Day programs are done today (12:30) and provides a look inside of Ike's Boyhood Home.

The Eisenhower Presidential Museum. Today's home school activities focus on the two World War II galleries, but there is much more to explore within the museum. We hope you will learn from the other seven galleries detailing Ike's life and times.



EXAMPLES OF POSSIBLE STUDENT SCHEDULES

Use these to draft your students' schedules **before** checking in to Home School Day. Each K-7 student has the opportunity to attend one ticketed program in their grade/age range, and two come & go activities which are open to all grade ranges. Your oldest scholars, in grades 8 - 12, can attend two different ticketed programs and the come & go activities.

STUDENT NAME Milly GRADE 2nd

time	Ticket required? Did you get it?	location	what	appr. grades?
9:30 - 10:15	<input type="checkbox"/> YES <input checked="" type="checkbox"/> NO <input checked="" type="checkbox"/> YES	museum, WWII galleries	WWII search	K-12
10:30 - 11:30	<input type="checkbox"/> YES <input checked="" type="checkbox"/> NO <input checked="" type="checkbox"/> YES	Library Courtyard	War Games	K-12
11:30 - 12:30	<input checked="" type="checkbox"/> YES <input type="checkbox"/> NO <input checked="" type="checkbox"/> YES	Library Auditorium	Little Ike Story Time: Parachute	K-3 YES

STUDENT NAME Billy GRADE 5th

time	Ticket required? Did you get it?	location	what	appr. grades?
9:30 - 10:15	<input checked="" type="checkbox"/> YES <input type="checkbox"/> NO <input checked="" type="checkbox"/> YES	visitors' center	Code Talkers	4-7 YES
10:30 - 11:30	<input type="checkbox"/> YES <input checked="" type="checkbox"/> NO <input checked="" type="checkbox"/> YES	museum, WWII galleries	WWII Search	K-12
11:30 - 12:30	<input type="checkbox"/> YES <input checked="" type="checkbox"/> NO <input checked="" type="checkbox"/> YES	Library Courtyard	War Games	K-12

STUDENT NAME Lilly GRADE 8th

time	Ticket required? Did you get it?	location	what	appr. grades?
9:30 - 10:30	<input checked="" type="checkbox"/> YES <input type="checkbox"/> NO <input checked="" type="checkbox"/> YES	Museum Classroom	Attic Artifacts: Band of Brothers	8-12 YES
10:30 - 11:20	<input type="checkbox"/> YES <input checked="" type="checkbox"/> NO <input checked="" type="checkbox"/> YES	Library Courtyard	War Games	K-12
11:30 - 12:20	<input checked="" type="checkbox"/> YES <input type="checkbox"/> NO <input checked="" type="checkbox"/> YES	Museum Classroom	Primarily Omaha Beach	8-12 YES

Use these to draft your students' schedules **before** checking in to Home School Day. Each K-7 student has the opportunity to attend one ticketed program in their grade/age range, and two come & go activities which are open to all grade ranges. Your oldest scholars, in grades 8 - 12, can attend two different ticketed programs and the come & go activities.

STUDENT NAME _____ AGE _____ GRADE _____

time	Ticket required? Did you get it?	location	what	appr. grades?
	<input type="checkbox"/> YES <input type="checkbox"/> NO <input type="checkbox"/> YES			
	<input type="checkbox"/> YES <input type="checkbox"/> NO <input type="checkbox"/> YES			
	<input type="checkbox"/> YES <input type="checkbox"/> NO <input type="checkbox"/> YES			
	<input type="checkbox"/> YES <input type="checkbox"/> NO <input type="checkbox"/> YES			

STUDENT NAME _____ AGE _____ GRADE _____

time	Ticket required? Did you get it?	location	what	appr. grades?
	<input type="checkbox"/> YES <input type="checkbox"/> NO <input type="checkbox"/> YES			
	<input type="checkbox"/> YES <input type="checkbox"/> NO <input type="checkbox"/> YES			
	<input type="checkbox"/> YES <input type="checkbox"/> NO <input type="checkbox"/> YES			
	<input type="checkbox"/> YES <input type="checkbox"/> NO <input type="checkbox"/> YES			

Use these to draft your students' schedules **before** checking in to Home School Day. Each K-7 student has the opportunity to attend one ticketed program in their grade/age range, and two come & go activities which are open to all grade ranges. Your oldest scholars, in grades 8 - 12, can attend two different ticketed programs and the come & go activities.

STUDENT NAME _____ AGE _____ GRADE _____

time	Ticket required? Did you get it?	location	what	appr. grades?
	<input type="checkbox"/> YES <input type="checkbox"/> NO ↓ <input type="checkbox"/> YES			
	<input type="checkbox"/> YES <input type="checkbox"/> NO ↓ <input type="checkbox"/> YES			
	<input type="checkbox"/> YES <input type="checkbox"/> NO ↓ <input type="checkbox"/> YES			
	<input type="checkbox"/> YES <input type="checkbox"/> NO ↓ <input type="checkbox"/> YES			

STUDENT NAME _____ AGE _____ GRADE _____

time	Ticket required? Did you get it?	location	what	appr. grades?
	<input type="checkbox"/> YES <input type="checkbox"/> NO ↓ <input type="checkbox"/> YES			
	<input type="checkbox"/> YES <input type="checkbox"/> NO ↓ <input type="checkbox"/> YES			
	<input type="checkbox"/> YES <input type="checkbox"/> NO ↓ <input type="checkbox"/> YES			
	<input type="checkbox"/> YES <input type="checkbox"/> NO ↓ <input type="checkbox"/> YES			

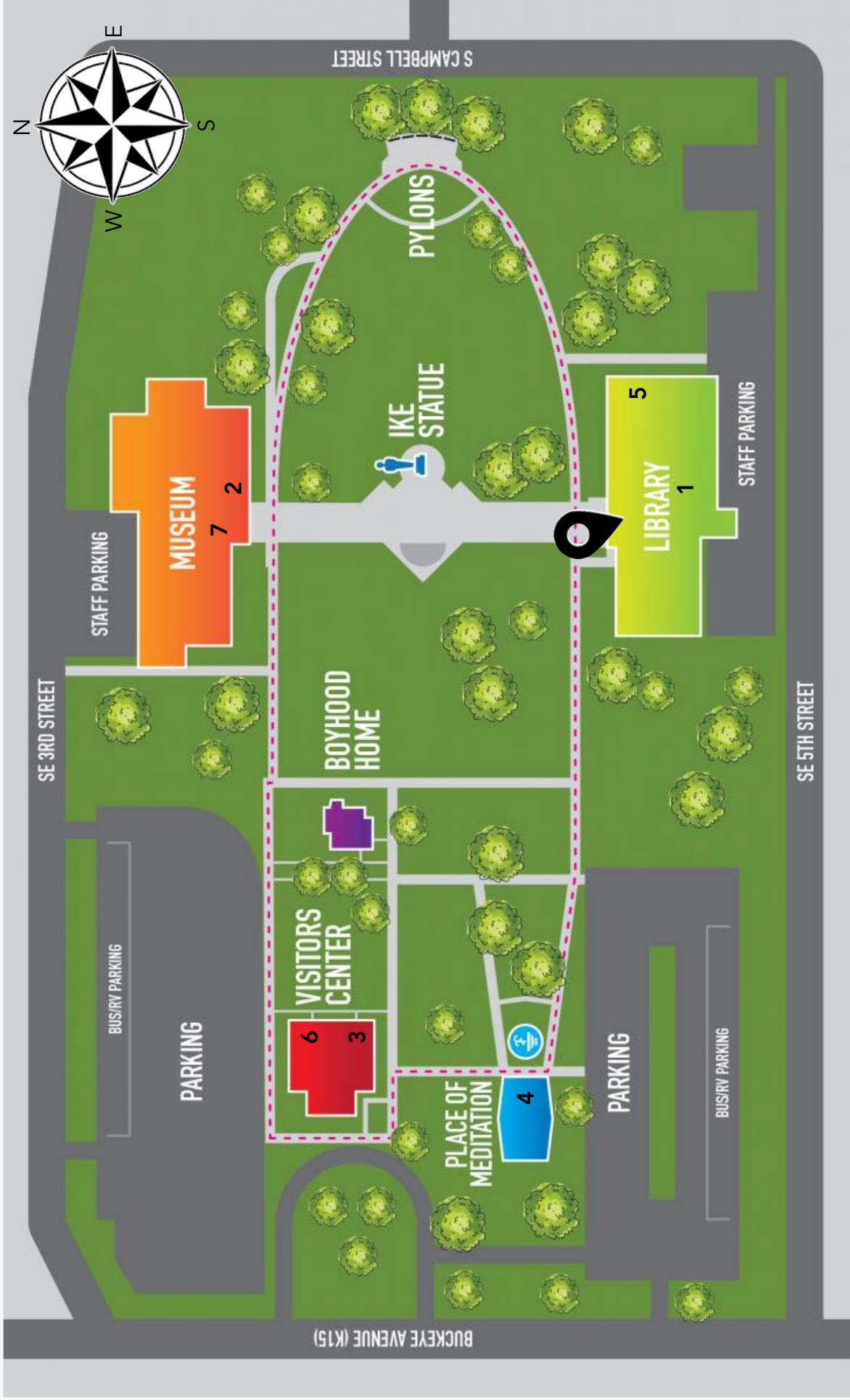

Come & Go



Check-in

1. Library Courtyard: War Games
2. Museum, WWII galleries: (east side of lobby): Activity sheets
3. IKE: An American Hero video: Visitor's Center, south auditorium
4. Place of Meditation
5. A Window to the Past video: Library auditorium

Ticket Required

5. Library Auditorium: Little Ike Storytime: Parachute
6. Visitors' Center: (northeast doors): Code Talkers
7. Museum Classroom: (line up on west side of lobby): Attic Artifacts, Band of Brothers; Primarily Omaha Beach